

Apartment – South Street, Taunton £850 PCM



KEY FEATURES

- CONVENIENT POSITION, EASY ACCESS INTO TOWN CENTRE
- MODERN 1ST FLOOR APARTMENT
- JUST OFF TAUNTON TOWN CENTRE IN TRINITY AREA
- OPEN PLAN MODERN KITCHEN/LOUNGE/DINER
- MODERN BATHROOM WITH SHOWER OVER THE BATH
- DOUBLE BEDROOM WITH FITTED WARDROBE
- GAS CENTRAL HEATING & DOUBLE GLAZED
- 1 ALLOCATED OFF ROAD PARKING SPACE
- HOLDING DEPOSIT FOR APPLICATION = £196.15
- CHECK-IN DEPOSIT = £980.75
- GROSS INCOME REQUIREMENT APPROS £29,143
- ENERGY RATING : C
- **AVAILABLE NOW**

Driving distances to...Town Centre- 0.5Miles Train Station- 1.3Miles M5 J25- 2.4Miles

This one-bedroom 1st floor apartment is ideally suited if you wish to walk into the town center or need to travel further afield. TAUNTON offers quick and easy access to the A38, A303, A358 and M5, which provide links to Bristol, Exeter, London and the central motorway network. There is also a direct mainline train from Taunton to Bristol & London - Paddington.

The accommodation – entrance hallway with storage cupboard, modern bathroom with shower over bath, open plan lounge/diner and modern kitchen. Outside, the property has 1 allocated parking space.

Available let unfurnished on an Assured Shorthold Tenancy for an initial six-month period at a rent of £850 per calendar month.

Pets: No

Smokers: No

Benefits: Sorry no benefit claimants can be considered for this property due to a restriction in the landlord's terms

Children: Not suitable

Sharers: N/A

Council Tax Band: A

Energy Rating: C

AVAILABLE:Now

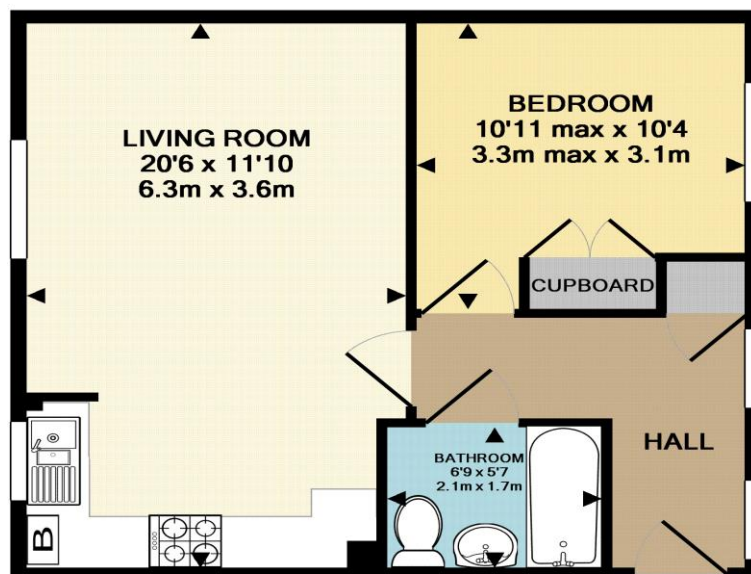

TOTAL APPROX. FLOOR AREA 453 SQ.FT. (42.0 SQ.M.)

Whilst every attempt has been made to ensure the accuracy of the floor plan contained here, measurements of doors, windows, rooms and any other items are approximate and no responsibility is taken for any error, omission, or mis-statement. This plan is for illustrative purposes only and should be used as such by any prospective purchaser. The services, systems and appliances shown have not been tested and no guarantee as to their operability or efficiency can be given

