

Galmington, Taunton - £600 PCM



KEY FEATURES

- CONVENIENT POSITION WITH GOOD ACCESS TO THE HOSPITAL & TOWN
- SOUGHT AFTER GALMINGTON AREA, CLOSE TO SHOPS/DOCTORS ETC
- VERY WELL PRESENTED REFURBISHED 1ST FLOOR APARTMENT
- GOOD SIZE LIVING ROOM/DINER WITH PATIO DOORS OUT TO A BALCONY
- WELL PRESENTED MODERN QUALITY KITCHEN
- 2 BEDROOMS WITH FITTED WARDROBES
- MODERN BATHROOM WITH A SHOWER OVER BATH
- GAS CENTRAL HEATING & DOUBLE GLAZING
- OFF ROAD PARKING AREA
- HOLDING DEPOSIT FOR APPLICATION = £138.46
- CHECK-IN DEPOSIT = £692.31
- **AVAILABLE 14TH OCTOBER**

Driving distances to...Town Centre-1.2Miles Train Station-1.9Miles M5 J25-3.6Miles

Bennett Residential have just received instructions to let this very well presented, refurbished TWO BEDROOM, first floor Apartment in the much sought after Galmington area of TAUNTON.

The accommodation is on the first floor a good sized living room/diner with patio doors out to a balcony, modern & well presented quality kitchen, 2 bedrooms with wardrobes and a modernised bathroom with a shower over the bath. Off road parking area. It is available to let unfurnished on an Assured Shorthold Tenancy for an initial six-month period at a rent of £600 per calendar month.

Pets: No

Smokers: No

Benefits: Considered with a suitable guarantor

Children: Older child considered

Sharers: 2 Professional only considered.

Energy Rating : C

Council Tax Band : B

AVAILABLE: 14 October

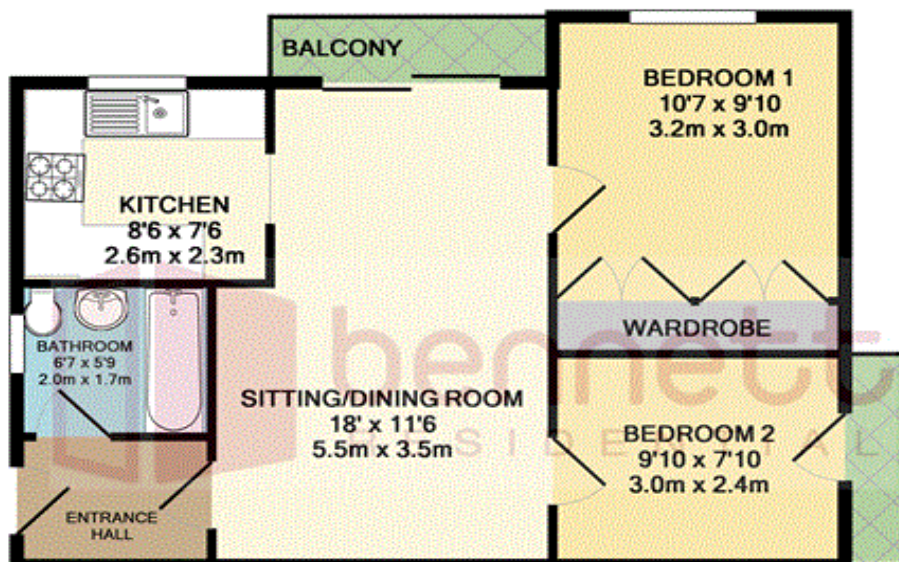

TOTAL APPROX. FLOOR AREA 526 SQ.FT. (48.8 SQ.M.)

Whilst every attempt has been made to ensure the accuracy of the floor plan contained here, measurements of doors, windows, rooms and any other items are approximate and no responsibility is taken for any error, omission, or mis-statement. This plan is for illustrative purposes only and should be used as such by any prospective purchaser. The services, systems and appliances shown have not been tested and no guarantee as to their operability or efficiency can be given

Made with Metrelix ©2019

